

Illustrated Index

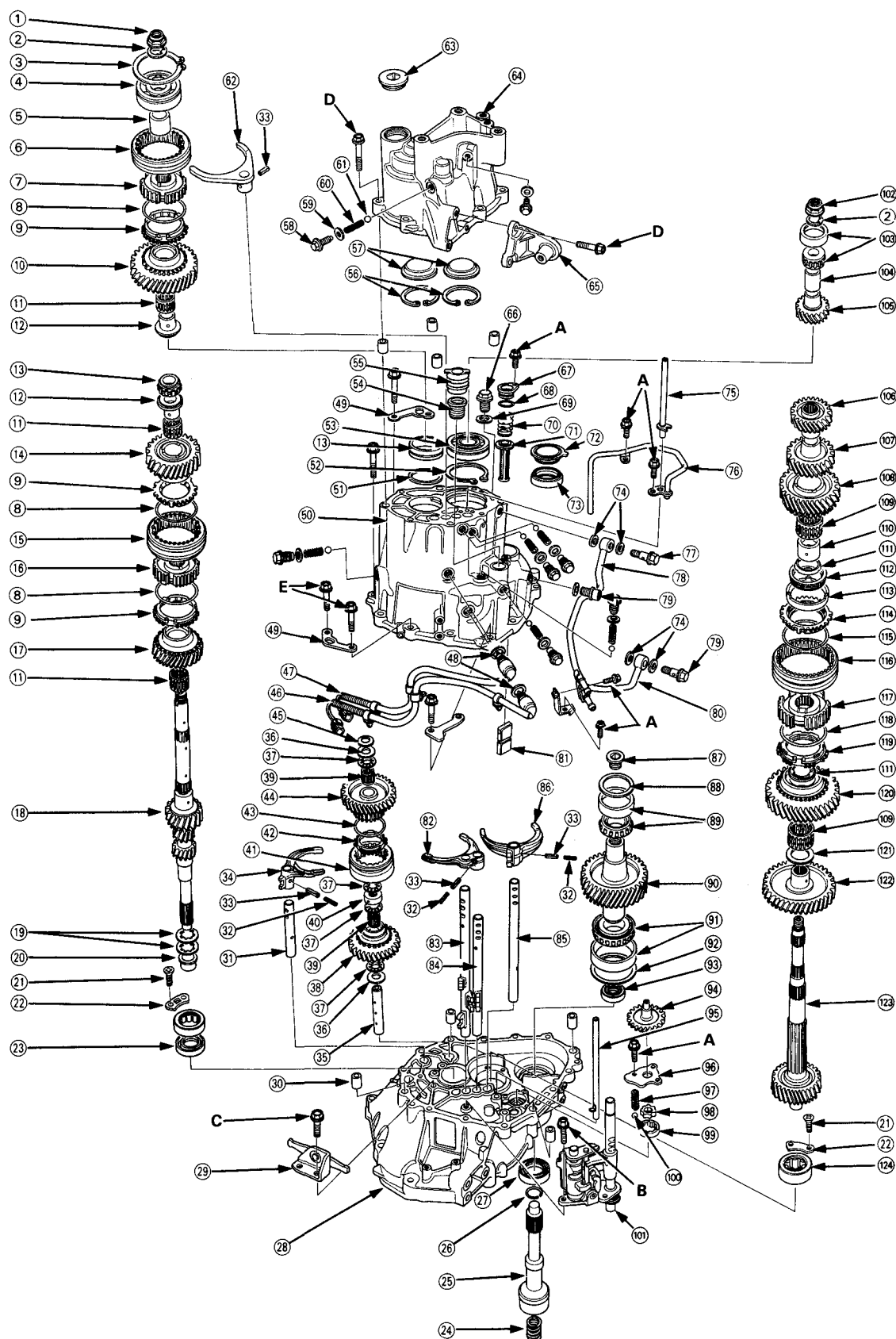



NOTE: Always clean the magnet ⑧2 whenever the transmission housing is disassembled.

Torque Value	Bolt Size
A – 12 N·m (1.2 kg·m, 9 lb·ft)	6 x 1.0 mm
B – 15 N·m (1.5 kg·m, 11 lb·ft)	6 x 1.0 mm
C – 26 N·m (2.6 kg·m, 19 lb·ft)	8 x 1.25 mm
D – 28 N·m (2.8 kg·m, 21 lb·ft)	8 x 1.25 mm
E – 45 N·m (4.5 kg·m, 33 lb·ft)	10 x 1.25 mm

- ① LOCKNUT Replace.
160 → 0 → 160 N·m
(16 → 0 → 16 kg·m,
116 → 0 → 116 lb·ft)
- ② SPRING WASHER
- ③ SNAP RING
- ④ BALL BEARING
- ⑤ 28 x 37 x 34 mm DISTANCE COLLAR
- ⑥ 5TH SYNCHRO SLEEVE
- ⑦ 5TH SYNCHRO HUB
- ⑧ SYNCHRO SPRING
- ⑨ SYNCHRO RING
- ⑩ 5TH GEAR
- ⑪ 38 x 44 x 29.5 mm NEEDLE BEARING
- ⑫ 31 x 38 x 34 mm DISTANCE COLLAR
- ⑬ NEEDLE BEARING
- ⑭ 4TH GEAR
- ⑮ 3RD/4TH SYNCHRO SLEEVE
- ⑯ 3RD/4TH SYNCHRO HUB
- ⑰ 3RD GEAR
- ⑱ MAINSHAFT
- ⑲ MAINSHAFT WASHER
- ⑳ 28 x 53 x 19 mm NEEDLE BEARING
- ㉑ FLAT SCREW Replace.
- ㉒ NEEDLE SET PLATE
- ㉓ 28 x 43 x 7 mm OIL SEAL Replace.
- ㉔ SECONDARY SPRING
- ㉕ EXTENSION SHAFT
- ㉖ SET RING Replace.
- ㉗ 55 x 75 x 11 mm OIL SEAL Replace.
- ㉘ CLUTCH HOUSING
- ㉙ REVERSE SHIFT HOLDER
- ㉚ 14 x 20 mm DOWEL PIN
- ㉛ REVERSE SHIFT FORK SHAFT
- ㉜ SPRING PIN 3 x 22 mm Replace.
- ㉝ SPRING PIN 5 X 22 mm Replace.
- ㉞ REVERSE SHIFT FORK
- ㉟ REVERSE GEAR SHAFT
- ㊱ 20 x 36 x 2 mm THRUST WASHER
- ㊲ 20 x 37 x 2.5 mm NEEDLE BEARING
- ㊳ REVERSE DRIVE GEAR
- ㊴ 20 x 25 x 26.5 mm NEEDLE BEARING
- ㊵ 20 x 36 x 9.5 mm DISTANCE COLLAR
- ㊶ REVERSE SYNCHRO SLEEVE
- ㊷ SYNCHRO RING
- ㊸ SYNCHRO SPRING
- ㊹ REVERSE SYNCHRO HUB
- ㊺ SPRING WASHER
- ㊻ BACK-UP LIGHT SWITCH
- ㊼ NEUTRAL SWITCH
- ㊽ 25 N·m (2.5 kg·m, 18 lb·ft)
- ㊾ WASHER Replace.
- ㊿ TRANSMISSION HANGER
- ①0 TRANSMISSION HOUSING
- ①1 62 mm SNAP RING
- ①2 78 mm SNAP RING
- ①3 32 x 78 x 20 mm BALL BEARING
- ①4 16 x 27 x 16 mm OIL SEAL Replace.
- ①5 SHIFT ROD BOOT
- ①6 SNAP RING
- ①7 OIL GUIDE PLATE
- ①8 SEALING BOLT
- ①9 WASHER Replace.
- ②0 SPRING
- ②1 STEEL BALL
- ②2 5TH SHIFT FORK
- ②3 SEALING BOLT
- ②4 25 N·m (2.5 kg·m, 18 lb·ft)
- ②5 TRANSMISSION COVER
- ②6 EXTENSION STAY
- ②7 OIL FILLER PLUG
- ②8 45 N·m (4.5 kg·m, 33 lb·ft)
- ②9 STRAINER COVER
- ③0 29.7 X 2.4 mm O-RING Replace.
- ③1 WASHER Replace.
- ③2 STRAINER SET SPRING
- ③3 OIL PUMP STRAINER
- ③4 SECONDARY COVER
- ③5 45 x 61 x 8 mm OIL SEAL Replace.
- ③6 WASHER Replace.
- ③7 OIL GUIDE PIPE
- ③8 REVERSE PIPE
- ③9 JOINT BOLT
- ④0 29 N·m (2.9 kg·m, 21 lb·ft)
- ④1 OIL PUMP PIPE B
- ④2 DRAIN PLUG
- ④3 40 N·m (4.0 kg·m, 29 lb·ft)
- ④4 OIL PUMP PIPE A
- ④5 MAGNET
- ④6 3RD/4TH SHIFT FORK
- ④7 5TH/REVERSE SHIFT FORK SHAFT
- ④8 3RD/4TH SHIFT FORK SHAFT
- ④9 1ST/2ND SHIFT FORK SHAFT
- ⑤0 1ST/2ND SHIFT FORK
- ⑤1 36 mm SEALING BOLT
- ⑤2 80 N·m (8.0 kg·m, 58 lb·ft)
- ⑤3 75 mm THRUST SHIM
- ⑤4 Selection, page 13-32
- ⑤5 TAPERED ROLLER BEARING
- ⑤6 SECONDARY GEAR
- ⑤7 TAPERED ROLLER BEARING
- ⑤8 90 mm THRUST WASHER
- ⑤9 37.5 x 47 x 7 mm OIL SEAL Replace.
- ⑥0 OIL PUMP SHAFT
- ⑥1 OIL GUIDE PIPE C
- ⑥2 OIL PUMP PLATE
- ⑥3 RELIEF VALVE SPRING (L. = 16.8 mm)
- ⑥4 OIL PUMP INNER
- ⑥5 OIL PUMP OUTER
- ⑥6 STEEL BALL (D. = 5/16 in)
- ⑥7 CHANGE HOLDER
- ⑥8 LOCKNUT Replace.
- ⑥9 160 → 0 → 160 N·m
(16 → 0 → 16 kg·m,
116 → 0 → 116 lb·ft)
- ⑦0 28 x 62 x 16 mm NEEDLE BEARING
- ⑦1 31 x 38 x 43 mm DISTANCE COLLAR
- ⑦2 5TH GEAR
- ⑦3 4TH GEAR
- ⑦4 3RD GEAR
- ⑦5 2ND GEAR
- ⑦6 47 x 53 x 31 mm NEEDLE BEARING
- ⑦7 SPACER COLLAR
- ⑦8 Selection, page 13-27
- ⑦9 FRICTION DAMPER
- ⑧0 INNER SYNCHRO RING
- ⑧1 SYNCHRO CONE
- ⑧2 OUTER SYNCHRO RING
- ⑧3 SYNCHRO SPRING
- ⑧4 1ST/2ND SYNCHRO SLEEVE
- ⑧5 1ST/2ND SYNCHRO HUB
- ⑧6 SYNCHRO SPRING
- ⑧7 SYNCHRO RING
- ⑧8 LOW GEAR
- ⑧9 60 mm THRUST SHIM
- ⑨0 Selection, page 13-27
- ⑨1 REVERSE GEAR
- ⑨2 COUNTERSHAFT
- ⑨3 33 x 62 x 22 mm NEEDLE BEARING